

STAND-ALONE iLEVEL® SHEAR BRACE INSTALLATION

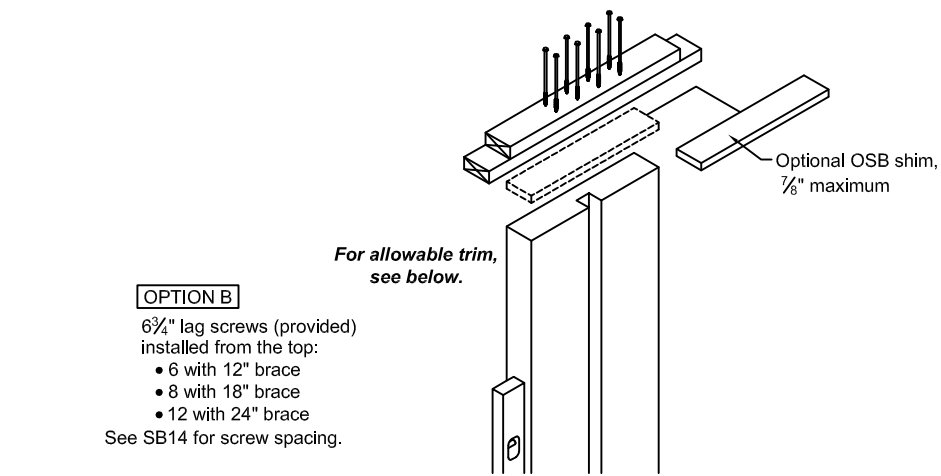

- Trim height from the top of the brace only. Do not trim the sides or bottom.
- Braces may be trimmed down to a minimum height of 74 1/2".

ALLOWABLE SMALL HOLES - ALL BRACES

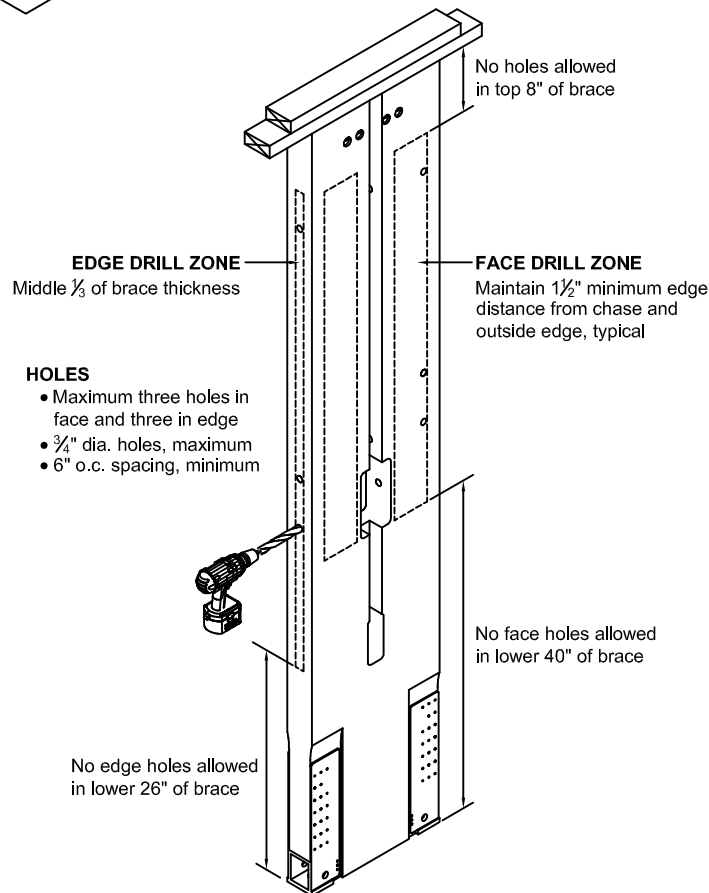

PORTAL FRAME COLUMN

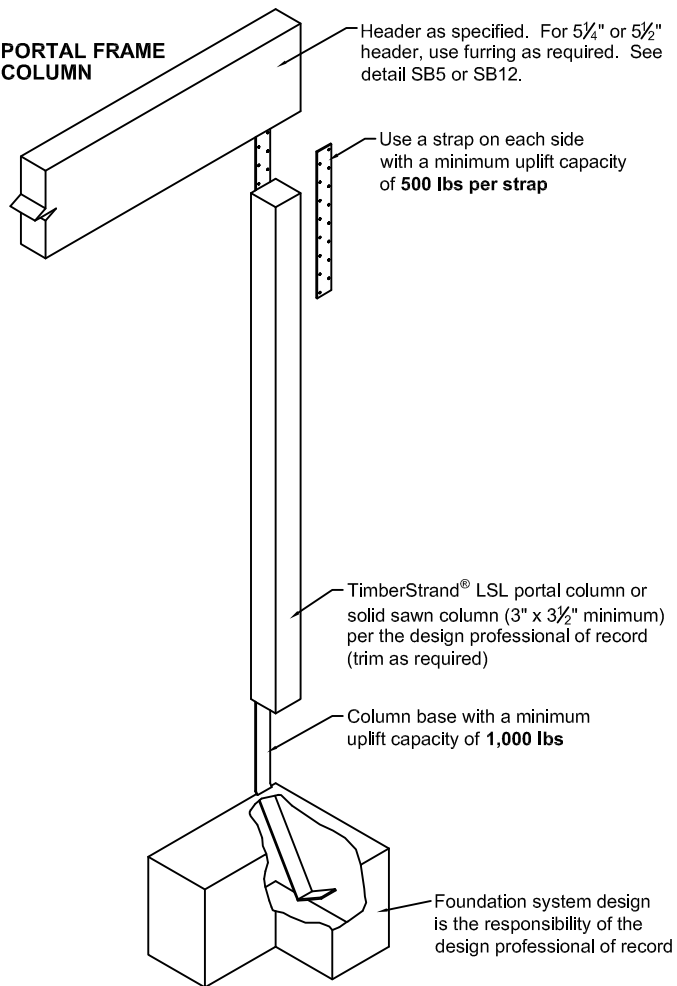

PORTAL FRAME SHEAR BRACE INSTALLATION

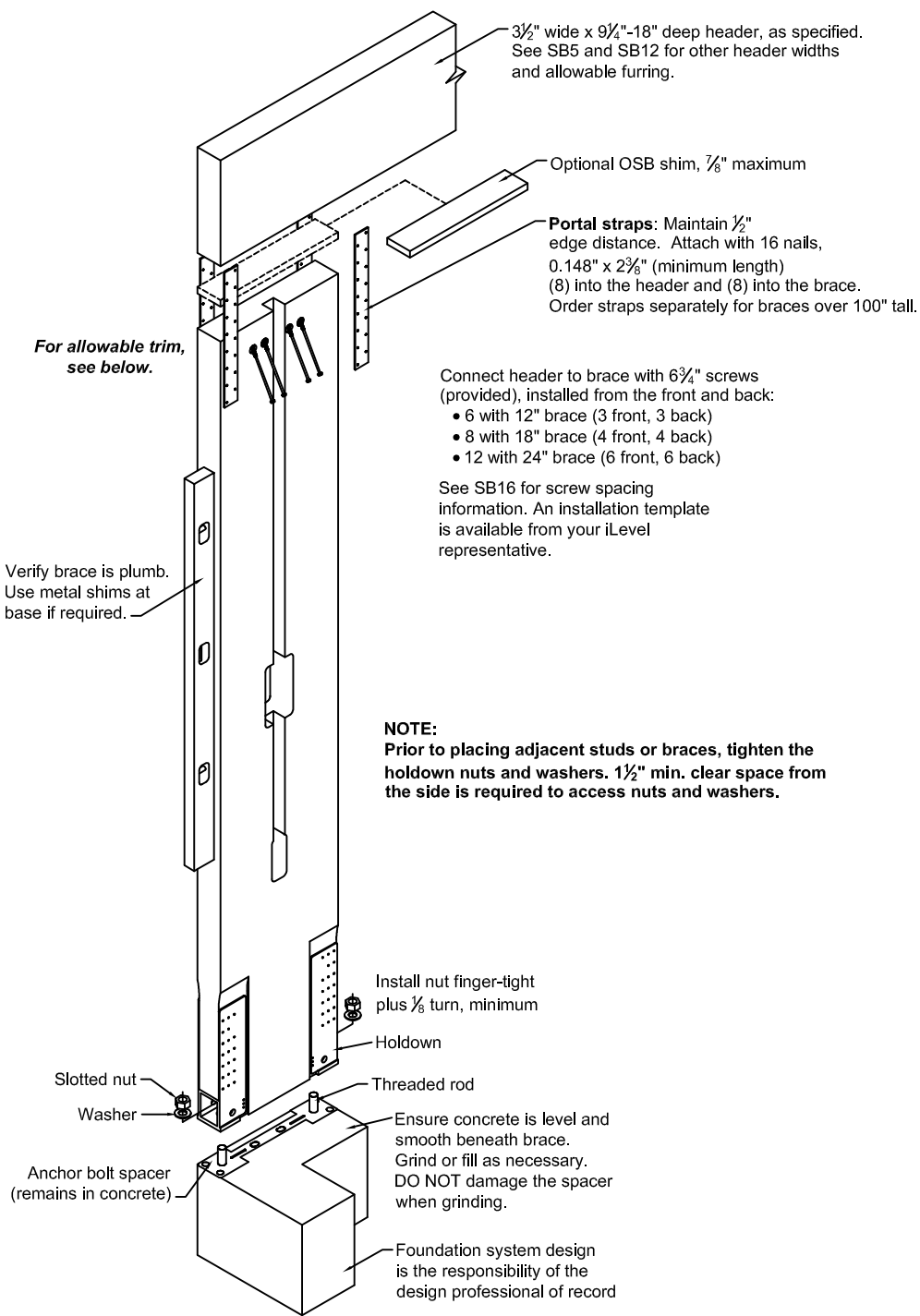

- Trim height from the top of the brace only. Do not trim the sides or bottom.
- Braces may be trimmed down to a minimum height of 74 1/2".

FILE LEVEL SHEAR BRACE

Installation Details

REV	BY	DATE	COMMENT
△			
△			
△			
△			
△			

PROJECT #:

SERVICE #:

SHEET

SB11 ALLOWABLE LARGE HOLES - ALL BRACES
(in addition to Small Holes in SB2)

HOLES

- 4 $\frac{5}{8}$ " dia. holes, maximum
- Maximum two 4 $\frac{5}{8}$ " dia.holes or one 4 $\frac{1}{4}$ " x 12" hole
- No minimum on-center spacing required

HOLES for 24x7 BRACE ONLY

- Maximum one 4 $\frac{5}{8}$ " x 6" hole
- 8" from top of brace, minimum

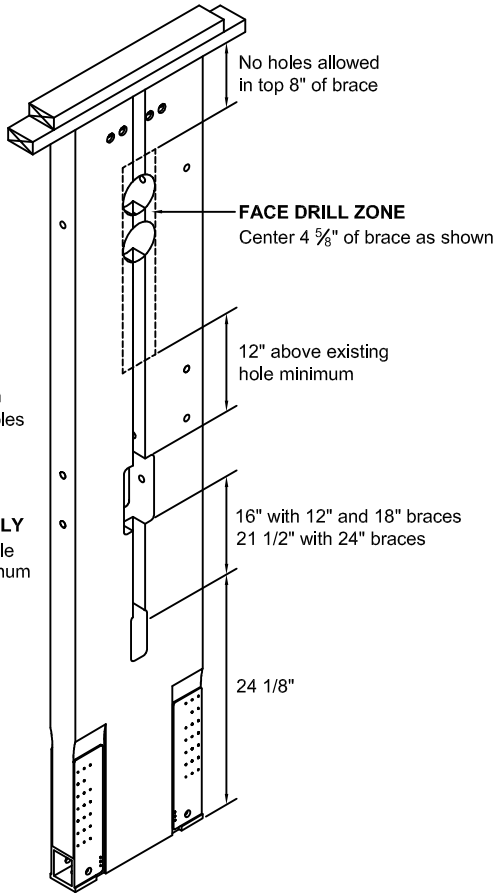

SB7 RAISED FLOOR KIT (RFK) INSTALLATION
(not applicable for 24" Shear Braces or braces over 12' tall)

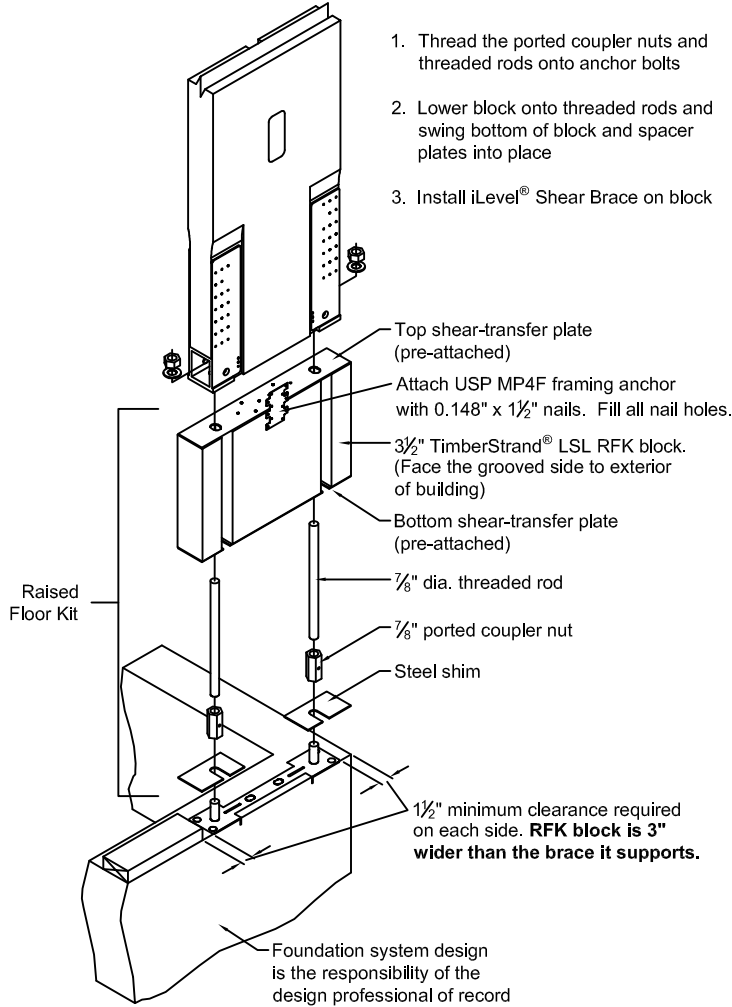

GENERAL NOTES

- DO NOT modify the Raised Floor Kit. For floor assemblies of non-standard heights (floor sheathing thicker than $\frac{3}{4}$ ", sill plates thicker than $1\frac{1}{2}$ ", or floor joists different than standard TJI® joist depths), adjust the total assembly height with steel shims or by trimming at the top of the iLevel® Shear Brace.
- Place the Raised Floor Kit directly on the concrete. DO NOT place on top of the sill plate.
- Attach floor joists to the RFK block using approved joist hangers. Alternatively, joists may rest on the remaining sill plate if adequate bearing is available.
- Notch floor sheathing around RFK block and iLevel® Shear Brace. Support the floor sheathing with a ledger attached directly to the block or iLevel® Shear Brace (depending on elevation requirements) to accommodate vertical loads and lateral load transfer. Use connections equivalent to the floor sheathing nailing schedule.
- The iLevel® Shear Brace must sit directly on the RFK top shear-transfer plate. Using compressible materials such as sheathing or wood shims in this area will affect the performance of the assembly.

SB10 STACKED BRACE INSTALLATION

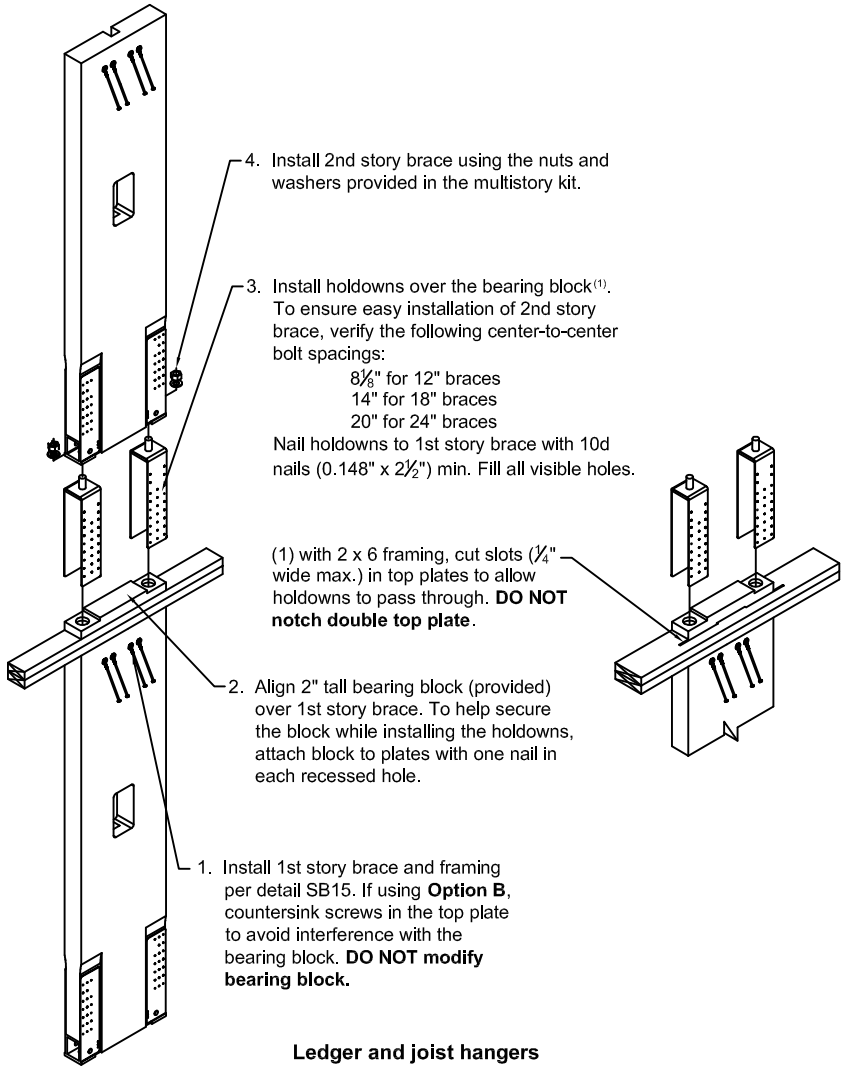

SB5 CONCENTRIC HEADER CONNECTION

For multiple ply headers, connect plies using the Multiple-Member Connections for Side-Loaded Beams table in TJ-9000, page 38.

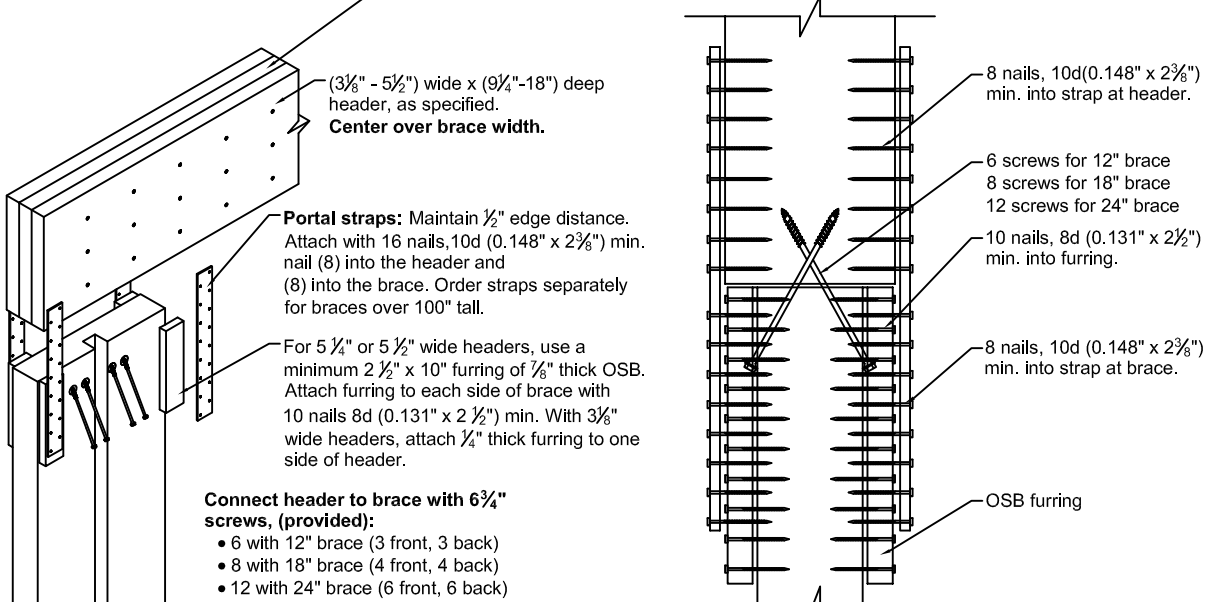

See SB16 for screw spacing

Furring strips may also be attached as shown in SB12

SB8 RFK INTERIOR VIEW
(not applicable for 24" shear braces or braces over 12' tall)

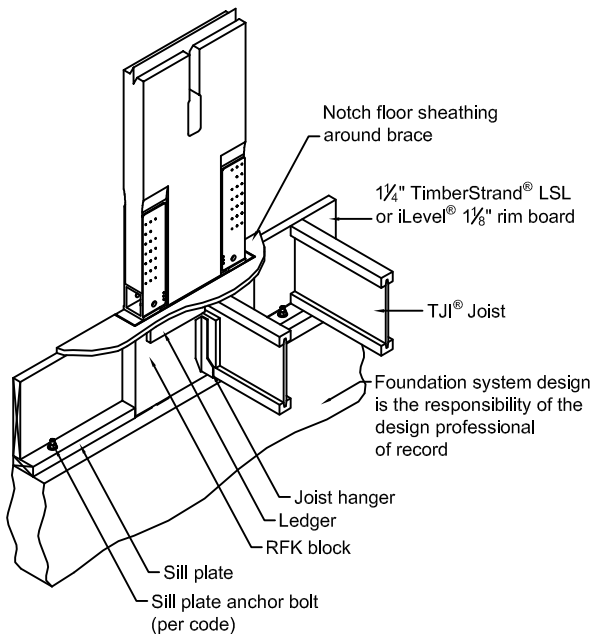

SB9 IN-LINE SHEAR BRACE
(recommended installation)

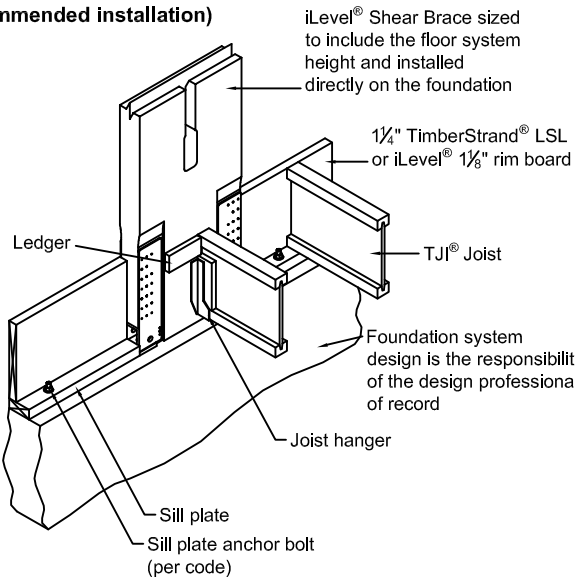

Weyerhaeuser, iLevel, Microllam, Parallam, Silent Floor, TimberStrand, TJI, and Trus Joist are registered trademarks of Weyerhaeuser NR. © 2010 Weyerhaeuser NR Company. All rights reserved. Printed in the USA.

August 2010 Reorder TJ-8615

SB12 Offset Header

For multiple ply headers, connect plies using the Multiple-Member Connections for Side-Loaded Beams table in TJ-9000, page 38.

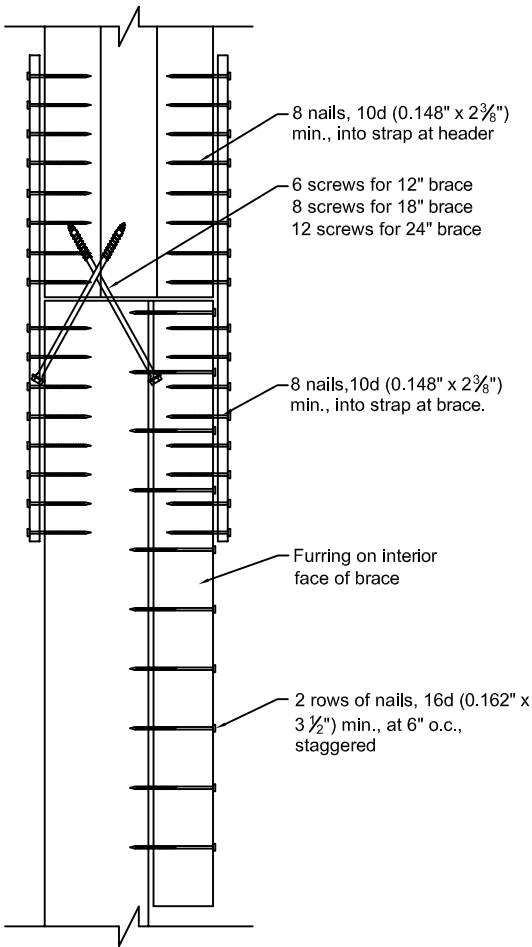
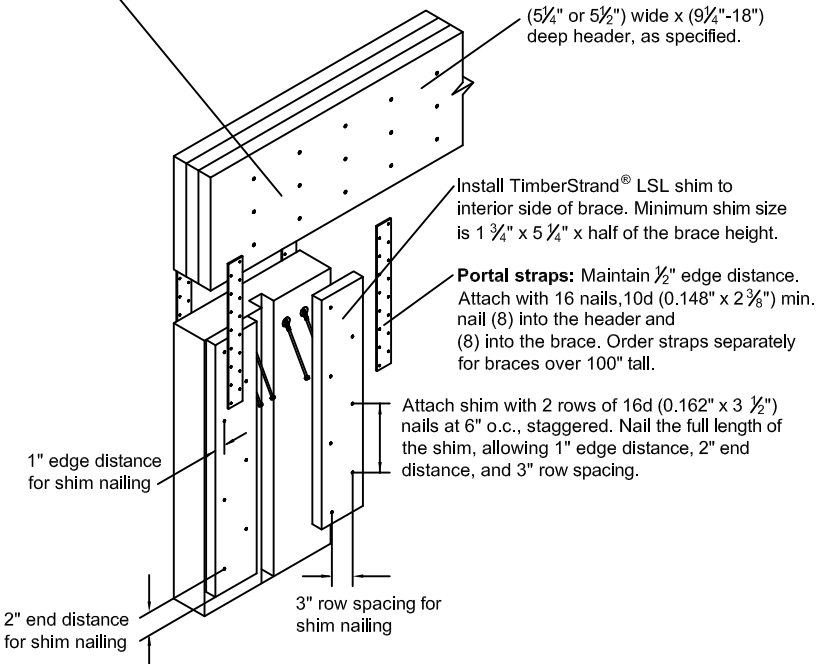

SB13 RAKE WALL

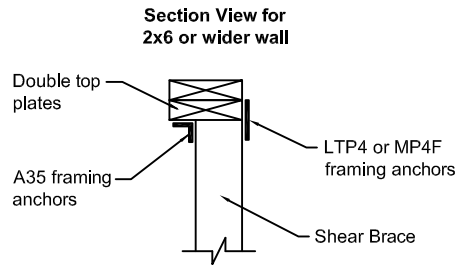
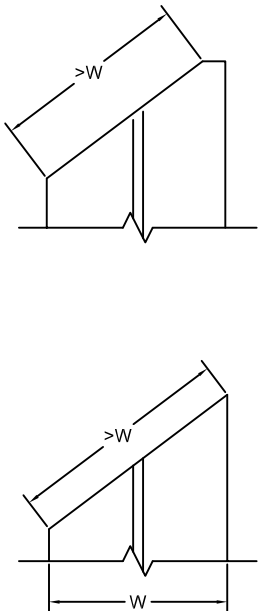
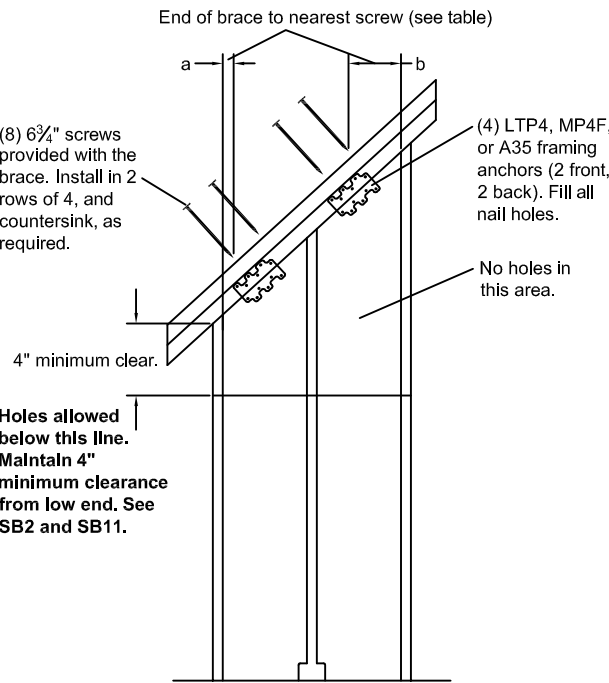

End Distance to Screws		
Slope	Distance a	Distance b
0:12 - 4:12	2"	3"
5:12 - 8:12	1 1/2"	4 1/2"
9:12 - 12:12	1/2"	5 1/2"

- Maintain end distances to prevent screws penetrating through the outer edges.
- Install screws perpendicular to the top plate.
- Edge distances assume double top plate.

- General Notes:
- Actual cut length must be greater than or equal to brace width (w).
 - For slopes up to 12:12.
 - Walls taller than 12' must be designed for the application.

SB14 Stand-Alone Brace - Screw Option A

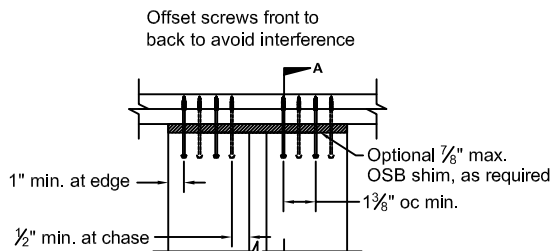

DO NOT install screws in center electrical chase.

Stand-Alone Brace - Screw Option B

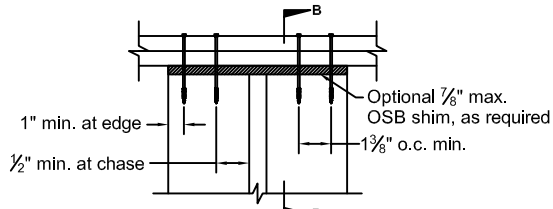

DO NOT install screws in center electrical chase.

SECTION A-A

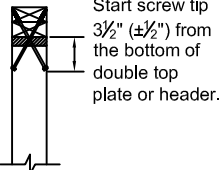

Install at an angle that prevents screws from exiting sides of top plates or header.

Optional: 1" diameter countersink, max. 1/4" deep.

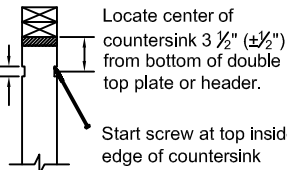

SECTION B-B

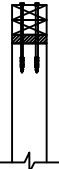

PLAN VIEW

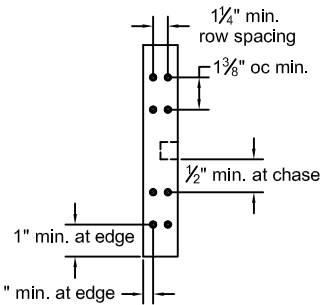

SB15 Multistory Brace - Screw Option A

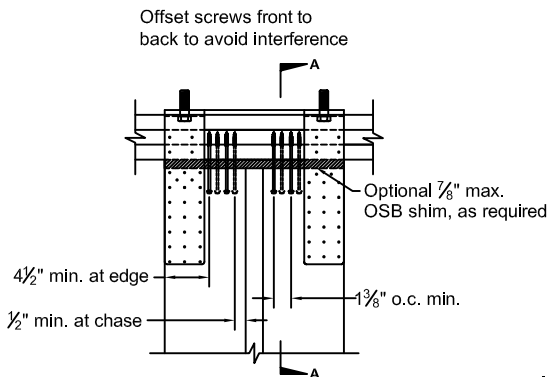

DO NOT install screws in center electrical chase from either side.

Multistory Brace - Screw Option B

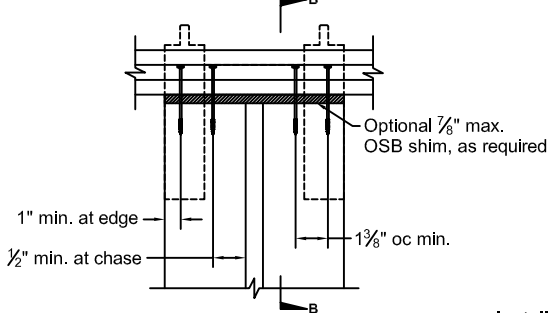

DO NOT install screws in center electrical chase. If a code inspection is required for the connection, have it performed prior to installing the bearing block on top.

SECTION A-A

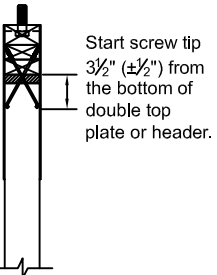

Install at an angle that prevents screws from exiting sides of top plates or header.

Optional: 1" diameter countersink, max. 1/4" deep.

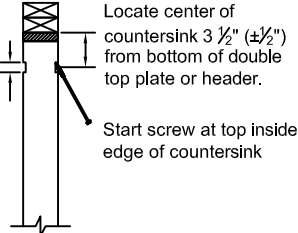

SECTION B-B



Install screws before installing bearing block. Countersink (1/2" max.) the screw heads into top plate to allow bearing block to sit flat.

PLAN VIEW

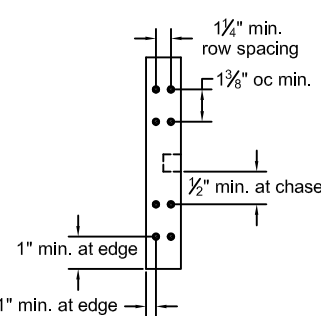

iLEVEL SHEAR BRACE
Installation Details

COMMENT

DATE

BY

REV

PROJECT #:

SERVICE #:

SHEET

3 of 4

SB16 PORTAL SCREW DETAIL

Portal straps: Maintain 1/2" edge distance. Attach with 16 nails, 10d (0.148" x 2 3/8") min. nail (8) into the header and (8) into the brace. Order straps separately for braces over 100" tall.

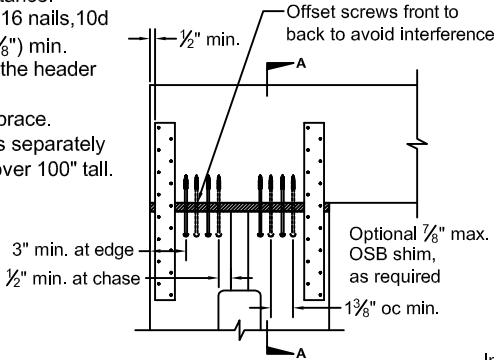

DO NOT install screws in center electrical chase from either side.

SECTION A-A

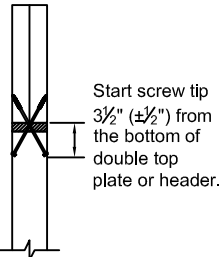

Optional: 1" diameter countersink, max. 1/4" deep.

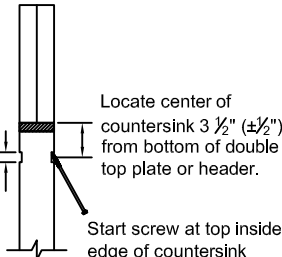

DO NOT USE OPTION B SCREW INSTALLATION WITH PORTAL APPLICATION

SB17 Tall Brace Framing (Braces over 18' tall)

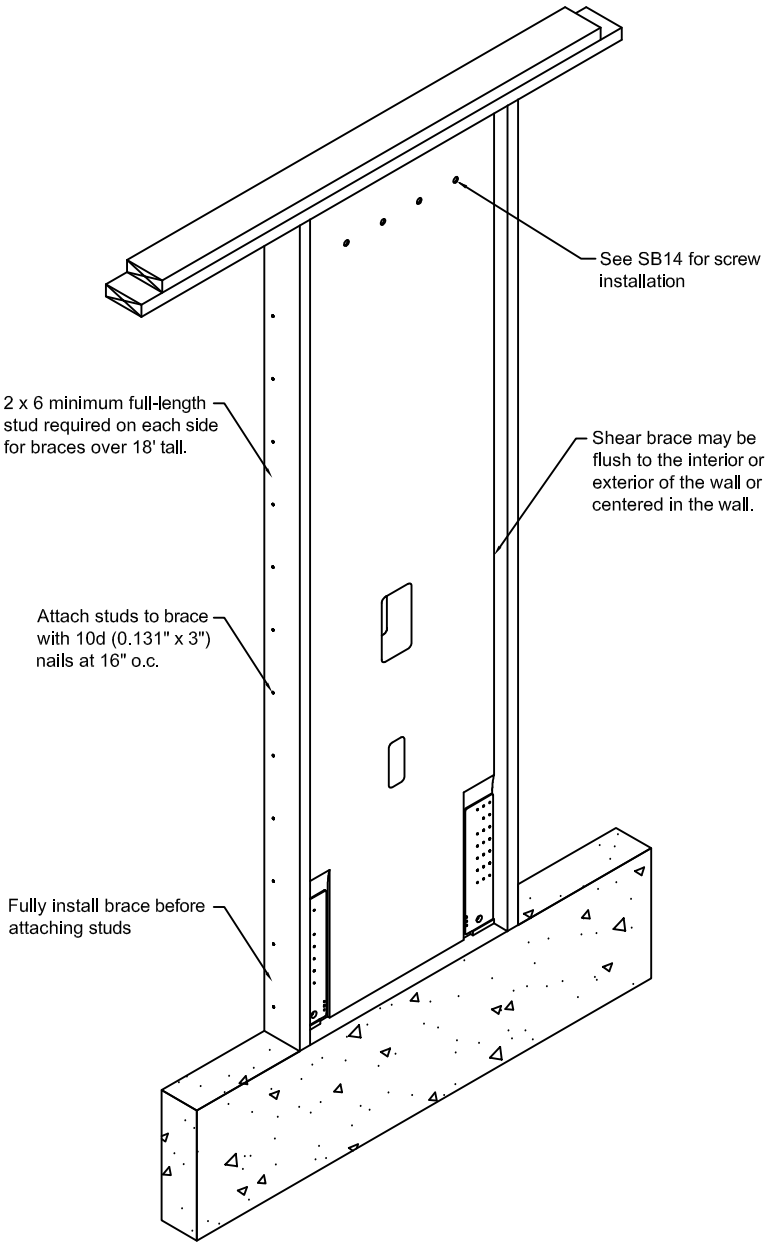

iLEVEL SHEAR BRACE
Installation Details

REV	BY	DATE	COMMENT
1			
2			
3			
4			
5			
6			
7			
8			
9			
10			

PROJECT #:
SERVICE #:
SHEET 4 of 4